

**Name of Each Part**

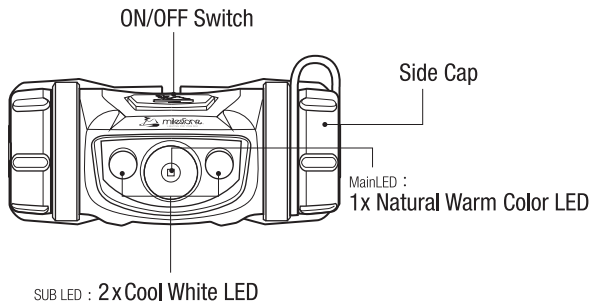

**Battery Exchange**

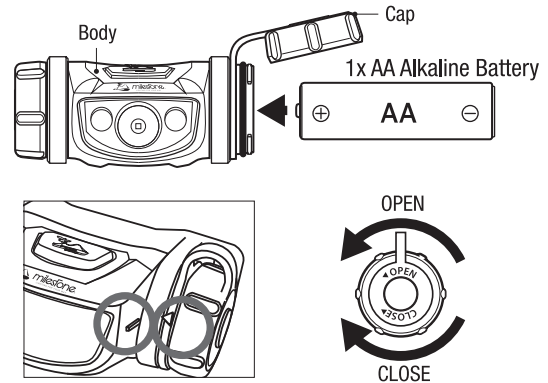

**Operating Method**

**Memory Wash**

Light will turn off, by Memory Wash, Enabled After 3secs passed

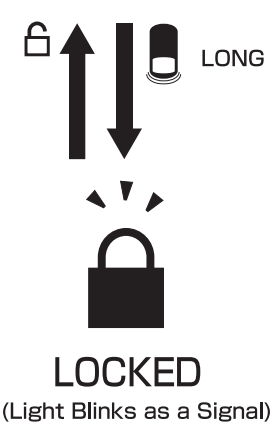
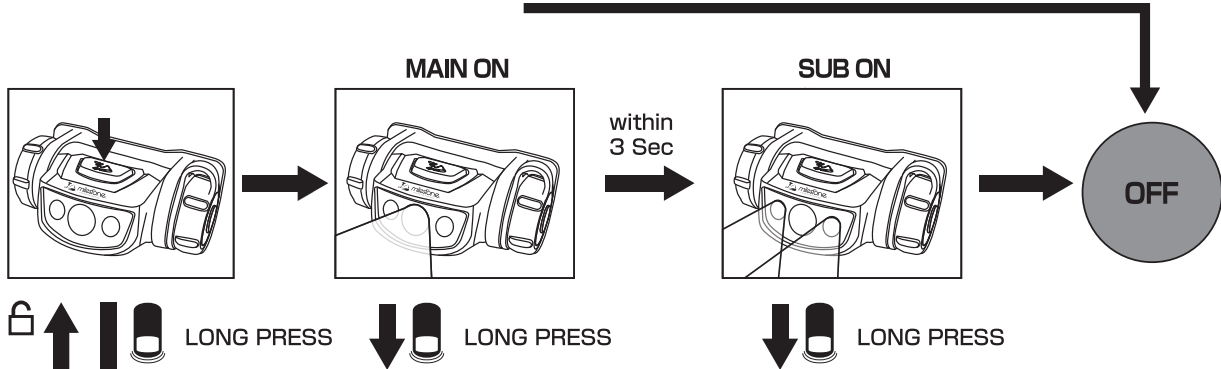

**Smart Control** [e.g. on Main LED]  
Brightness goes Back and Force Until Release your Finger



100% ← → 10%

---

**Dimming Memory**  
MS-A4 Keeps Brightness that Last time used.



KEEP X% BRIGHTNESS

**How to Reset “ Dimming Memory ”**  
Press Switch after take away Battery .